



# Tiny House On Wheels



**GLOBAL** ACQUIRE

📍 PO BOX 259 Salisbury SA5108    ☎️ 0418 927 396

✉️ michael@GlobalAcquire.com.au

LICENCE REG NO.BLD292790

**GLOBAL** ACQUIRE



COMFORT



CONVENIENT



LUXURIOUS



## FLOOR PLAN

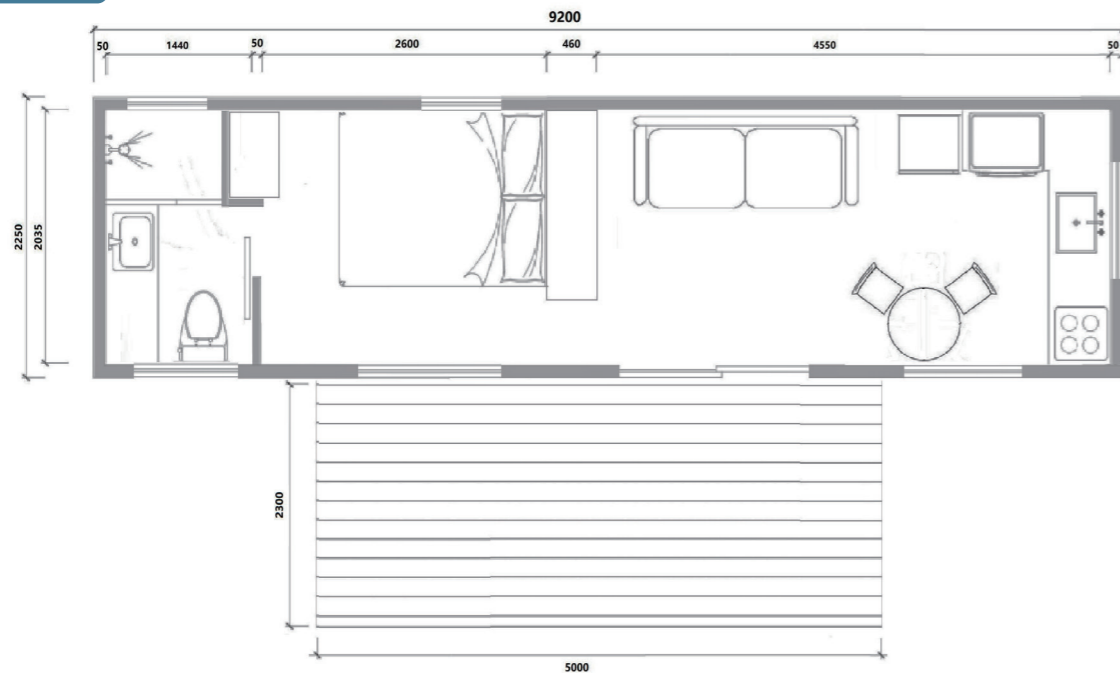

## TECHNICAL SPECIFICATIONS

### Trailer & Dimensions

- Built on a galvanised, heavy duty trailer
- Three axles, with each wheel electrically braked
- Safety breakaway, all clearance lights, wind down jacks
- House length: 9.2m
- House width: 2.25m
- Height: 3.0m
- Trailer length (with drawbar): 10.7m
- Weight: Approx. 4.5 tonne (empty)

### Building Materials

- Built with sustainable galvanise steel frames
- Aluminium framed windows and door (Double glazed)
- Large entry sliding door, awning windows and bathroom sliding door
- 16mm PU insulated exterior cladding in grey and white colour
- Walls, ceiling and underfloor insulated with 50mm XPS (blue panel)
- 50mm EPS insulated roof panel
- Internal walls lined with 4mm SPC waterproof wall panel
- Premium, durable, sustainable SPC flooring
- Soft-close drawers and cupboards throughout

## INTERNAL FEATURES

### Electrical / Gas / Plumbing

- 3.5kW split system air-con included
- Instantaneous gas hot water system (LPG)
- Ample power points throughout
- LED lighting throughout
- Simple plug-in to mains (240V, 32A)
- Switchboard with circuit breakers and RCDs
- Two outdoor taps at each side
- Standard inlet fitting to connect to water supply
- Standard grey water outlet
- Ventilation in living room and bedroom

### Kitchen

- Large L-shape kitchen with storage
- Premium quartz stone bench top
- Modern large sink with black tap fittings
- 2-burner induction cooktop included (Electric)
- Rangehood included
- Space for fridge
- Space for front-loading washing machine

### Bathroom

- Vanity unit with quartz stone bench top
- High quality, modern hand basin and tap
- Large mirror
- Traditional flush toilet
- Tempered glass framed shower
- High quality, modern black fixtures
- Extraction fan



### Lounge / Living

- Cabinet with shelf and storage
- Space for comfortable couch
- Space for a dining table and chair
- Space for wall mounted TV

### Bedroom

- Queen-size bed with storage
- Queen-size mattress
- Wardrobe storage

### Outdoor Living

- Extra large 5.0m x 2.3m (LxW) veranda with roof
- High quality WPC decking
- Modern style handrail
- Entrance steps